

# ASSEMBLY INSTRUCTIONS FOR HOUSEKEEPING CART

## Plastic Parts:

- 1 x base
- 1 x top
- 2 x side wall
- 2 x doors
- 2 x back wall
- 1 x bottom drawer
- 2 x shelves

## Spare Parts:

- 2 x wheels with brakes
- 2 x wheels (fixed)
- 4 x side wheels
- 1 x u-shaped steel frame
- 16 x M7x7.5cm bolts
- 16 x M7 nuts
- 16 x M7 washers
- 12 x 10x20mm screws

- 8 x 10x30mm screws
- 20 x 6.5mm washers
- 4 x spring washers
- 4 x 8mm washers
- 2 x 2x9cm bolt
- 2 x steel ferrule
- 4 x nut caps
- 2 x zipper garbage bags

## Tools:

- Electric Screw Driver
- Mallet



**WARNING: THIS IS A 2 PERSONS ASSEMBLING, HEAVY LIFTING REQUIRED**

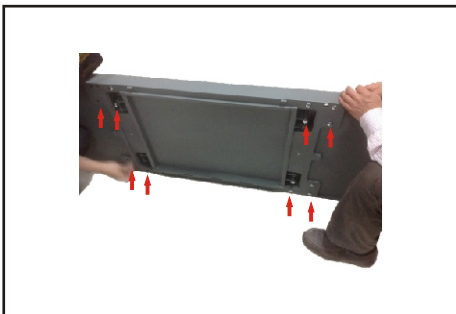

1. Place 16 M7x7.5cm bolts in position shown in image no. 1



2. Bolts must be fully inserted as shown

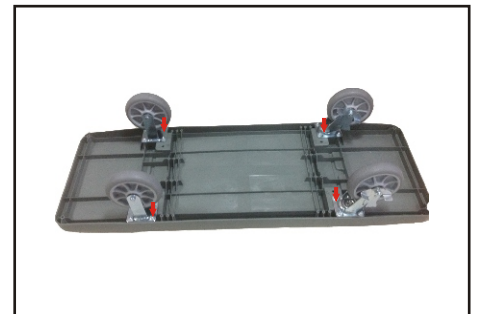

3. Turn base upside down and tighten all the bolts with washers and nuts

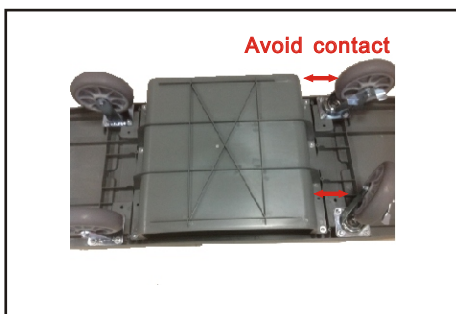

4. Install base drawer, make sure the swivel wheel can turn 360° freely.

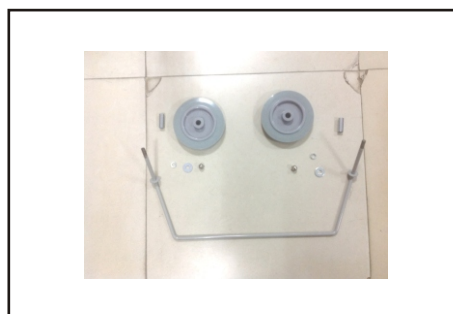

5. Install side wheels on the steel frame as shown, metal ferrule and spring washers are needed for this side.



6. Place nut caps on top as shown.



7. Install the other side with side wheels using the 2 longest bolt and nut



8. Tighten the nut on top side as shown

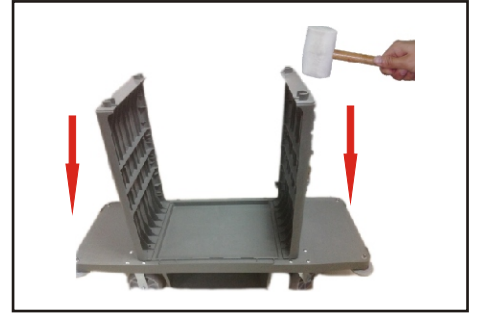

9. Install side walls as shown using a mallet and hit the side wall until firmly placed in position as shown



10. Install back wall horizontally, make sure all connectors are in the right positions

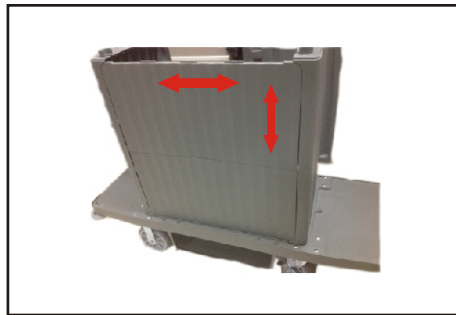

11. Install top back wall, make sure no gaps are visible from the back

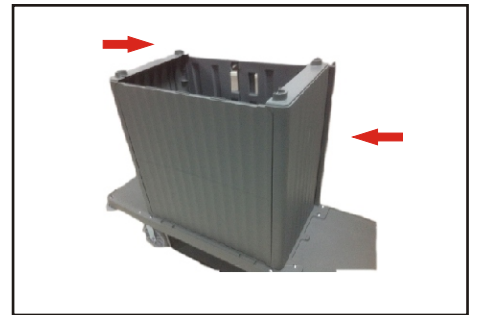

12. Install doors in at the front, make sure door locks are in locked status



13. Place the top on and secure all plastic parts using screws and washers



14. Place shelves on and secure with screws



15. Attached garbage bags on the side to complete the installation